

Broaching Head 265

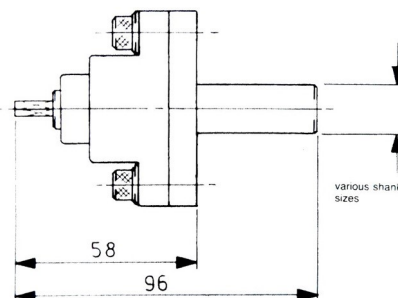
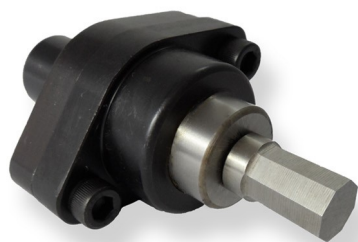

A broaching head designed primarily to produce hexagonal holes without stopping the spindle.

This is the smallest of the range designed to suit the smaller auto or CNC lathe.

Capacity	Shank Dia Ø	Bearing Repair Kit	
1.5mm-6mm	16mm	265K	
0.050"-1/4"	5/8"		

Broaching Head 275

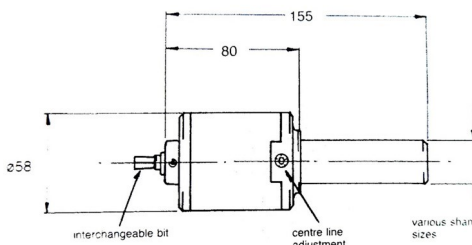

This head is designed primarily for producing hexagonal holes. A micro screw is provided to set the cutting bit on the machine centre line. The inner shaft is mounted on sealed ball races for precision and long life.

R.H. and L.H. rotation is possible to produce a component. The cutting bits can be rapidly replaced and are available in a range of both metric and imperial sizes.

Capacity	Shank Dia Ø	Bearing Repair Kit	
2mm-10mm	16mm 20mm 22mm 25mm 32mm 40mm 50mm	275K	
5/64"-3/8"	5/8" 3/4" 1" 1"1/4 1"1/2 1"3/4 2"		
	2MT 3MT		

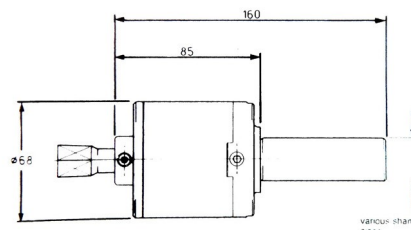

Broaching Head 295



A larger version of code 275 but with increased capacity. All technical features remain the same.

Capacity	Shank Dia Ø	Bearing Repair Kit	
6mm-19mm	16mm 20mm 22mm 25mm 32mm 40mm 50mm	295K	
1/4"- 3/4"	5/8" 3/4" 1" 1"1/4 1"1/2 1"3/4 2"		
	2MT 3MT		

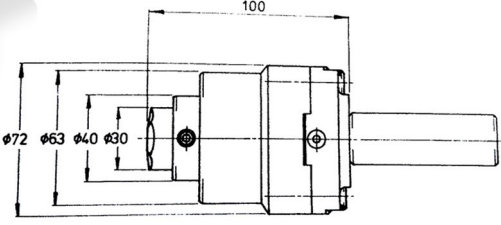
Broaching Head 1500



The external broaching head has been developed to produce hexagon and square forms and turned parts during the turning cycle on capstans, auto's, CNC lathes, etc.

To produce a form, pre-turn a diameter to the across corner dimension, keep spindle rotating, index to tool station with external broaching head, advance tool, the cutting bit will start to revolve when picked up and driven by the turned part, advance to depth and retract.

The external broaching head compliments the internal head and is available with various shank diameters including VDI.

Capacity	Shank Dia Ø	Bearing Repair Kit
3mm-16mm	20mm 25mm 32mm	1500K
1/8" - 5/8" A/F HEX	3/4" 1" 1 1/4"	



Broaching Head 1600/1

Internal



External



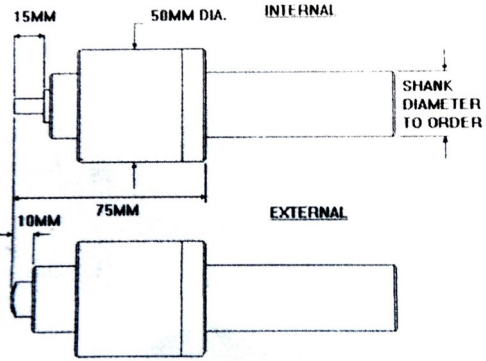

This universal model offers the versatility of being both an internal and external head, easily converted from one to the other with the exchange of operating shafts codes 1602 and 1612.

Various shank sizes available:
Metric 16-20-25
Imperial 5/8" – 3/4" - 1".

Capacity	Shank Dia Ø
Internal - 1.5mm-10mm	20mm 25mm 32mm
External - 2mm-14mm A/F HEX	3/4" 1" 1 1/4"